

Team Name	Div	BARN	CAMP SITES
Alpena	A	24	494-496
Bullock Creek	A	29	307-314,315-323
Caledonia	A	22	504-507,509-512
Chippewa Hills	A	36	342-352
Hudsonville	A	39	359-360
Lakeland	A	18	231-233,258-260
Lowell	A	18	.197-202
Midland	A	39	371-392
Milford	A	24	234-240,251-257
Rockford	A	39	353-357
Cedar Springs	B	22	361-370
FGR	B	18	NA
Freeland	B	29	330-341
Gladwin	B	24	191-196,206-211
Goodrich	B	24	Gazebo, 514-520
Hopkins	B	21	144-154
Manton	B	29	304-306,323-326
Mason Co E	B	36	521-522
Oxford	B	18	185-190,212-217
St Joseph	B	18	130-134,163-167
Zeeland West	B	39	393-414
Alma	C	24	126-129,168-171
Clarkston	C	18	498-502
Forest Hills Central	C	24	Next to Pond E
Grand Blanc	C	24	91-93,97-99
Grand Haven	C	36	490-492
Holly	C	24	182-184,218-220
Ludington	C	36	482-488
Meridian	C	21	135-141,157-162
Sparta	C	21	87-89,101-103
Vicksburg	C	36	Between 22/25
Capac	D	18	143,153
CMH HS	D	21	NA
Essexville Garber	D	24	Playground N
Fruitport	D	36	493
Michigan Luthern	D	18	Playground
Morenci	D	29	297-298
Romeo	D	29	NA
Saranac	D	18	203-205
Southgate And	D	18	294-296
St Charles	D	24	523

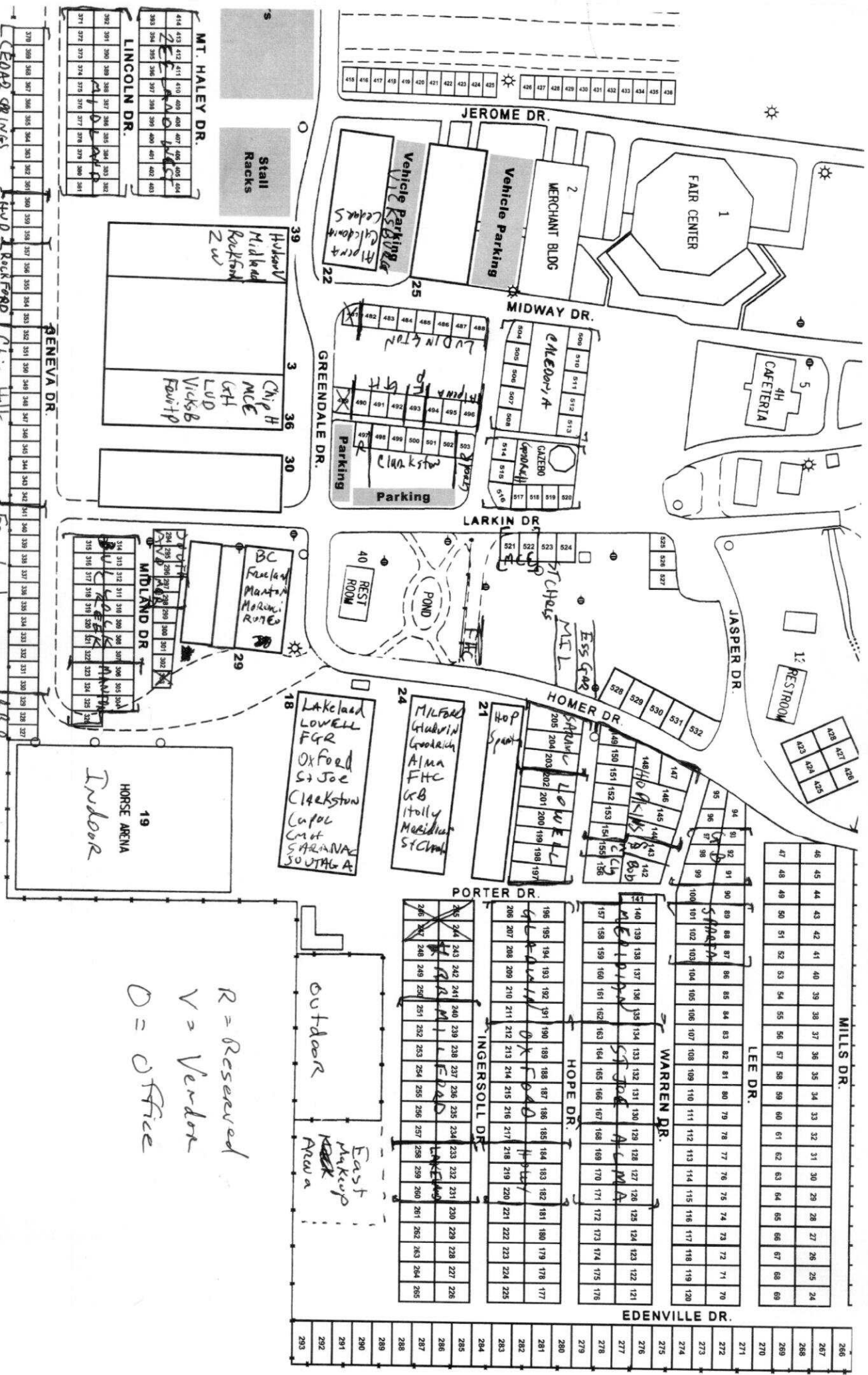

414	415	416	417	418	419	420	421	422	423	424	425
426	427	428	429	430	431	432	433	434	435	436	437
438	439	440	441	442	443	444	445	446	447	448	449
450	451	452	453	454	455	456	457	458	459	460	461
462	463	464	465	466	467	468	469	470	471	472	473
474	475	476	477	478	479	480	481	482	483	484	485
486	487	488	489	490	491	492	493	494	495	496	497
498	499	500	501	502	503	504	505	506	507	508	509
510	511	512	513	514	515	516	517	518	519	520	521
522	523	524	525	526	527	528	529	530	531	532	533
534	535	536	537	538	539	540	541	542	543	544	545
546	547	548	549	550	551	552	553	554	555	556	557
558	559	560	561	562	563	564	565	566	567	568	569
570	571	572	573	574	575	576	577	578	579	580	581
582	583	584	585	586	587	588	589	590	591	592	593
594	595	596	597	598	599	600	601	602	603	604	605
606	607	608	609	610	611	612	613	614	615	616	617
618	619	620	621	622	623	624	625	626	627	628	629
630	631	632	633	634	635	636	637	638	639	640	641
642	643	644	645	646	647	648	649	650	651	652	653
654	655	656	657	658	659	660	661	662	663	664	665
666	667	668	669	670	671	672	673	674	675	676	677
678	679	680	681	682	683	684	685	686	687	688	689
690	691	692	693	694	695	696	697	698	699	700	701
702	703	704	705	706	707	708	709	710	711	712	713
714	715	716	717	718	719	720	721	722	723	724	725
726	727	728	729	730	731	732	733	734	735	736	737
738	739	740	741	742	743	744	745	746	747	748	749
750	751	752	753	754	755	756	757	758	759	760	761
762	763	764	765	766	767	768	769	770	771	772	773
774	775	776	777	778	779	780	781	782	783	784	785
786	787	788	789	790	791	792	793	794	795	796	797
798	799	800	801	802	803	804	805	806	807	808	809
810	811	812	813	814	815	816	817	818	819	820	821
822	823	824	825	826	827	828	829	830	831	832	833
834	835	836	837	838	839	840	841	842	843	844	845
846	847	848	849	850	851	852	853	854	855	856	857
858	859	860	861	862	863	864	865	866	867	868	869
870	871	872	873	874	875	876	877	878	879	880	881
882	883	884	885	886	887	888	889	890	891	892	893
894	895	896	897	898	899	900	901	902	903	904	905
906	907	908	909	910	911	912	913	914	915	916	917
918	919	920	921	922	923	924	925	926	927	928	929
930	931	932	933	934	935	936	937	938	939	940	941
942	943	944	945	946	947	948	949	950	951	952	953
954	955	956	957	958	959	960	961	962	963	964	965
966	967	968	969	970	971	972	973	974	975	976	977
978	979	980	981	982	983	984	985	986	987	988	989
990	991	992	993	994	995	996	997	998	999	1000	1001

MIHA 2019 State Championships

Horse Barn #18



West End(Homer Dr Bathrooms)

1	FGR	Clarkston	20	39	Clarkston	Lowell	58	77	Lowell	Lowell	96
2	FGR	Clarkston	21	40	Clarkston	Lowell	59	78	Lowell	Lowell	97
3	FGR	Clarkston	22	41	Clarkston	Lowell	60	79	Lowell	St Joseph	98
4	FGR	Clarkston	23	42	Clarkston	Lowell	61	80	Lowell	St Joseph	99
5	FGR	CMH	24	43	Saranac	Lowell	62	81	Lowell	St Joseph	100
6	FGR	CMH	25	44	Saranac	Lowell	63	82	Lowell	St Joseph	101
7	FGR	CMH	26	45	Saranac	Lowell	64	83	Lowell	St Joseph	102
8	FGR	Southgate Anderson	27	46	Saranac	Lowell	65	84	Lowell	St Joseph	103
9	FGR	Southgate Anderson	28	47	Saranac	Lowell	66	85	Michigan Luthern	St Joseph	104

10	FGR	Lakeland	29	48	Lakeland	Lowell	67	86	Michigan Luthern	St Joseph	105
11	FGR	Lakeland	30	49	Lakeland	Lowell	68	87	Michigan Luthern	St Joseph	106
12	FGR	Lakeland	31	50	Lakeland	Oxford	69	88	Oxford	St Joseph	107
13	FGR	Lakeland	32	51	Lakeland	Oxford	70	89	Oxford	St Joseph	108
14		Lakeland	33	52	Lakeland	Oxford	71	90	Oxford	St Joseph	109
15	Lakeland	Lakeland	34	53	Lakeland	Oxford	72	91	Oxford	St Joseph	110
16	Lakeland	Lakeland	35	54	Lakeland	Oxford	73	92	Oxford	St Joseph	111
17	Lakeland	Lakeland	36	55	Lakeland	Oxford	74	93	Oxford	Capac	112
18	Lakeland	Lakeland	37	56	Lakeland	Oxford	75	94	Oxford	Capac	113
19	Lakeland	Lakeland	38	57	Lakeland	Oxford	76	95	Oxford	Capac	114

East End(Outside Arena)

MIHA 2019 State Championships

Horse Barn #21



West End(Homer Dr--Playground Area)

20	CMH	Sparta	1
21	CMH	Sparta	2
22	CMH	Sparta	3
23		Sparta	4
24		Sparta	5
25		Sparta	6
26		Sparta	7
27		Sparta	8
28	Hopkins	Sparta	9
29	Hopkins	Sparta	10
30	Hopkins	Meridian	11
31	Hopkins	Meridian	12
32	Hopkins	Meridian	13
33	Hopkins	Meridian	14
34	Hopkins	Meridian	15
35	Hopkins	Meridian	16
36	Hopkins	Meridian	17
37	Hopkins	Meridian	18
38	Hopkins	Meridian	19

38 PERMENANT STALLS

East End(Porter Dr--Camping)

MIHA 2019 State Championships

Horse Barn #22



East End (Midway Dr--Arenas)

Alpena	1	15	Alpena	Caledonia	29	43	Caledonia
Alpena	2	16	Alpena	Caledonia	30	44	Caledonia
Alpena	3	17	Alpena	Caledonia	31	45	Caledonia
Alpena	4	18	Alpena	Caledonia	32	46	Caledonia
Alpena	5	19	Alpena	Caledonia	33	47	Caledonia
Cedar Springs	6	20	Cedar Springs	Caledonia	34	48	Caledonia
Cedar Springs	7	21	Cedar Springs	Caledonia	35	49	Caledonia
Cedar Springs	8	22	Cedar Springs	Caledonia	36	50	Caledonia
Cedar Springs	9	23	Cedar Springs	Caledonia	37	51	Caledonia
Cedar Springs	10	24	Cedar Springs	Caledonia	38	52	Caledonia
Cedar Springs	11	25	Cedar Springs	Caledonia	39	53	Caledonia
	12	26	Cedar Springs	Caledonia	40	54	
	13	27			41	55	
	14	28			42	56	

West End (Overflow Camping)

56 PORTABLES

MIHA 2019 State Championships

Horse Barn #24



West End(Home Dr Pond/Restroom)

		49	Holly	Gladwin	48	1	Gladwin
Holly	95	50	Holly	Gladwin	47	2	Gladwin
Holly	94	51	Holly	Gladwin	46	3	Gladwin
Holly	93	52	Holly	Gladwin	45	4	Gladwin
Holly	92	53	Holly	Gladwin	44	5	Gladwin
Holly	91	54	FHC	Gladwin	43	6	Gladwin
Alma	90	55	FHC	Alpena	42	7	Alpena
Alma	89	56	FHC	Alpena	41	8	Alpena
Alma	88	57	FHC	Alpena	40	9	Alpena
Alma	87	58	FHC	Alpena	39	10	Alpena
Alma	86	59	FHC	Grand Blanc	38	11	Alpena
Alma	85	61	FHC	Grand Blanc	37	12	Alpena
Alma	84	62	St Charles	Grand Blanc	36	13	Essexville Garber

Alma	83	60	St Charles	Grand Blanc	35	15	Essexville Garber
Alma	82	63	St Charles	Grand Blanc	34	16	Essexville Garber
Milford	81	64	Milford	Grand Blanc	33	17	Goodrich
Milford	80	65	Milford	Grand Blanc	32	18	Goodrich
Milford	79	66	Milford	Goodrich	31	19	Goodrich
Milford	78	67	Milford	Goodrich	30	20	Goodrich
Milford	77	68	Milford	Goodrich	29	21	Goodrich
Milford	76	69	Milford	Goodrich	28	22	Goodrich
Milford	75	70	Milford	Goodrich	27	23	Goodrich
Milford	74	71	Milford	Goodrich	26	24	Goodrich
Milford	73	72	Milford	Goodrich	25		

95 PERMANENT STALLS

East End (Porter Dr --Camping Area)

MIHA 2019 State Championships

Horse Barn #29



East End(Arenas)

50	Manton	Manton
51	Manton	Manton
52	Manton	Manton
53	Manton	Manton
54	Manton	Manton
55	Chip Hills	Freeland
56	Morenci	Freeland
57	Morenci	Freeland
58	Morenci	Freeland
59	Morenci	Freeland
60		
61		

POSSIBLE TEMPERARY STALLS 35 IF AVAILABLE

27	Freeland	Bullock Creek
28	Freeland	Bullock Creek
29	Freeland	Bullock Creek
30	Freeland	Bullock Creek
31	Freeland	Bullock Creek
32	Freeland	Bullock Creek
33	Freeland	Bullock Creek
34	Freeland	Bullock Creek
35	Freeland	Bullock Creek
36	Freeland	Bullock Creek
37	Freeland	Bullock Creek

16	1	Bullock Creek
17	2	Bullock Creek
18	3	Bullock Creek
19	4	Bullock Creek
20	5	Bullock Creek
21	6	Bullock Creek
22	7	Bullock Creek
23	8	Bullock Creek
24	9	Bullock Creek
25	10	Romeo
26	11	Romeo
	12	Romeo
	13	Romeo
	14	Romeo
	15	Romeo

West End(Office)

37 PERMENANT STALLS

24 ADDITIONAL PORTABLE STALLS IF NEEDED

MIHA 2019 State Championships

Horse Barn #36



North End(Greendale Dr--Ctr of Fairgrounds)

Ludington	1				50		
Ludington	2	18	Ludington	Grand Haven	34	51	
Ludington	3	19	Ludington	Grand Haven	35	52	Grand Haven
Ludington	4	20	Ludington	Grand Haven	36	53	Grand Haven
Ludington	5	21	Ludington	Grand Haven	37	54	Grand Haven
Ludington	6	22	Ludington	Grand Haven	38	55	Grand Haven
Ludington	7	23	Ludington	Grand Haven	39	56	Fruitport
Mason Co E	8	24	Ludington	Fruitport	40	57	Fruitport
Mason Co E	9	25	Mason Co E	Fruitport	41	58	Chippewa Hills
Mason Co E	10						
		26	Mason Co E	Chippewa Hills	42	59	Chippewa Hills
Mason Co E	11	27	Mason Co E	Chippewa Hills	43	60	Chippewa Hills
Mason Co E	12	28	Mason Co E	Chippewa Hills	44	61	Chippewa Hills
Mason Co E	13	29	Mason Co E	Chippewa Hills	45	62	Chippewa Hills
Vicksburg	14	30	Mason Co E	Chippewa Hills	46	63	Chippewa Hills
Vicksburg	15	31	Vicksburg	Chippewa Hills	47	64	Chippewa Hills
Vicksburg	16	32	Vicksburg		48	65	Chippewa Hills
Vicksburg	17	33	Vicksburg		49	66	Chippewa Hills

South End(Geneva Dr--Armory Side)

66 PORTABLE STALLS

MIHA 2019 State Championships

Horse Barn #39



North End(Greendale Dr--Ctr of Fairgrounds)

Hudsonville	1					50	Rockford
Hudsonville	2	18	Hudsonville	Rockford	34	51	Rockford
Hudsonville	3	19	Hudsonville	Rockford	35	52	Rockford
Hudsonville	4	20	Hudsonville	Rockford	36	53	Rockford
Hudsonville	5	21	Hudsonville	Rockford	37	54	Rockford
Hudsonville	6	22	Hudsonville	Rockford	38	55	Rockford
Hudsonville	7	23	Hudsonville	Rockford	39	56	Rockford
Midland	8	24	Hudsonville	Rockford	40	57	Rockford
Midland	9	25	Midland	Rockford	41	58	Rockford

Midland	10	26	Midland	Zeeland W	42	59	Rockford
Midland	11	27	Midland	Zeeland W	43	60	Zeeland W
Midland	12	28	Midland	Zeeland W	44	61	Zeeland W
Midland	13	29	Midland	Zeeland W	45	62	Zeeland W
Midland	14	30	Midland	Zeeland W	46	63	Zeeland W
Midland	15	31	Midland	Zeeland W	47	64	Zeeland W
Midland	16	32	Midland	Zeeland W	48	65	Zeeland W
Midland	17	33	Midland	Midland	49	66	Zeeland W

South End(Geneva Dr--Armory Side)

66 PORTABLE STALLS