



35th Annual

1974-2009

2009 MIHA State
Championship

**Midland County Fairgrounds
Midland, Michigan**

October 15 – 18, 2009



*Congratulations
and best wishes to all
of the teams in this year's
2009 MIHA
State Championship!!!*

Welcome to the Show Page 1

Fairground Rules Page 6

Show Staff Page 2

MIHA Appreciation Page Page 7

Show Judges Page 2

Fairground Map Pages 8-9

Tentative Show Schedule Page 3

Rider Information (all divisions) Pages 12-17

History of the MIHA Page 4

Team, District and Business Ads Pages 18-27

Code of Conduct Page 5

State Show Evaluation Form Page 28

2009 MIHA Officers

State Chairperson

Chris Cook
580 West Unadilla Street
Pinckney, MI 48169
(810) 599-2191 (Cell)
ccook7634@sbcglobal.net (E-mail)

Vice Chairperson

Dennis Stanton
2380 M Drive South
Athens, MI 49011
(269) 579-2265
stantondennis@yahoo.com (E-mail)

Vice Chairperson

Mike Yanz
905 Dakin Rd.
Dansville, MI 48819
(517) 819-5468
mikey0530@yahoo.com (E-mail)

Secretary

Pattie Yanz
905 Dakin Rd.
Dansville, MI 48819
(517) 819-5468
jjscuriosity@yahoo.com (E-mail)

Rules Chairperson

Joann Kosanic
13309 Rich St.
Grand Haven, MI 49417
(616) 846-7473
jokosanic@hotmail.com (E-mail)

Treasurer

Chene Godsey
29240 Philadelphia Drive
Chesterfield, MI 48051
(586) 201-3868 (Cell)
chenegodsey@gmail.com (E-mail)

State Show Chairperson

Cindy Tesolin
2075 S. Garner
Milford, MI 48380
(248) 685-7699 (Home)
bonnieview2@comcast.net (E-mail)



Welcome to the MIHA's 35th Annual State Championship!

Welcome to the Michigan Interscholastic Horsemanship Association's State Championship! We would like to congratulate all of the teams and riders competing this year. Not only were you District champs, but also you were tops at your Regional competitions.

We have made some changes to our show schedule in this past couple of years, which we think will help make things run smoother. We have placed all Fitting & Showing on one day, so the poor horses won't have to freeze to death with multiple baths if the weather is bad. We placed the bareback classes opposite the saddle classes for the same seat, so there will be less outfit and tack changes. We have added a set crew to set courses, instead of having volunteers from the teams set the patterns.

Getting any horse show to run smoothly can be a challenge, so we ask for your patience if we hit a few bumps along the way. Please remember that this organization is run entirely by volunteers. We will try our best to be polite and respectful to you, and ask that you treat our show staff equally well. Please read the "Code of Conduct"; also, please read and follow the Midland County Fairground Rules.

You will find a **tentative** show schedule, we say tentative because it is subject to change at any moment. Our plan is to start the show at 8:00 a.m. and continue as scheduled through the classes listed for that day. However, certain factors may speed up or slow down the start times for some of the classes. We ask for your cooperation as we try to keep the show moving.

Your thoughts and concerns are important to us! Please take a few moments to fill out and turn in the show evaluation form found in the back of this program. Please do not hesitate to contact our Executive Board members to give us your feedback directly.

We look forward to a great competition! We wish all of our teams and riders good luck!



2009 MIHA State Championship Show Staff

MIHA Chairman Chris Cook
State Show Chair Cindy Tesolin
Office Managers Chene Godsey
Office Staff Dennis Stanton, Kyle Stanton
Score Keeper Fred Stockley, Chris Forbes
Judging Manager Mike Yantz, Jo Ann Kozick
Ring Stewards Deb Yanke, Adela Leark, Kristen Cook
Paddock Masters Benny Cunningham, Greg Cartwright, Mike Cook
Announcers Tiffany Spedowski, Pattie Yanz, Marc DeLisle
Communications Mike Yantz
Set Crew Audrey Karnes, Win Likert, Drew Abbott
Pre-Show Prep Executive Board, Office Staff
Judges Scripes Cyndi Dreim, Lisa Calcut, Michelle Krull, Lynn Olivier

THANK YOU TO DISTRICT ONE AND DISTRICT SIX FOR PROVIDING ALL OF THE SHOW EQUIPMENT. YOUR SERVICE IS GREATLY APPRECIATED!

Gate Duty

All regions will share gate duty.

Region A – Thursday, Outdoor & Indoor arena all day

Region B – Friday, Outdoor all day

Region C – Friday, Indoor arena all day

Region D – Saturday, Outdoor and Indoor arena all day

Region E – Sunday, Outdoor and Indoor arena all day

Show Service Providers

EMT Chris Baldwin Catering Carousel Catering
Veterinarian Dr. Robert Renton Golf Carts Titan Golf Carts
Farrier Brent Hewitt Printer Worldcolor Midland
Judge Transportation Mike Yantz Photographer Frawgbyte

State Show Vendors

(All vendors are located inside the SWINE Building behind the MIHA Main Office)

Rick's Tack & Supply
Sliding S Ranch

Holbrook Tack
Cowgirlz Clozet

2009 MIHA State Championship Judges

Charles Schroeder
Delaware, OH

Mike Tucker
Fenwick, Ontario

Dan Grunewald
Jefferson, WI

Carol Craig
Crown Point, IN

Duane Esser
Cleves, OH

Susan Martin
Marengo, IL



2009 Tentative Show Schedule

We say tentative because it is subject to change at any moment. Our plan is to start the show at 8:00 a.m. and continue through the classes listed for that day. However, certain factors may speed up or slow down the start times for some of the classes. For example, if the judging runs faster than expected, then the classes will start earlier than listed on the tentative show schedule.

Likewise, if the judging runs slower than expected, then the classes will start later than listed on the tentative show schedule. Other conditions may speed up, slow down, or alter our schedule as well. Please keep track of how fast the show is running and be flexible.

Date	Time	Location	Event	Division/Order
Thursday 10/15/09	9:00 a.m.	Fairgrounds	TEAM ARRIVAL Use Airport Rd gate (US-10 service drive)	ALL Trucks, Trailers, Campers
	11:00 – 12 noon	Outside	Trail Walk Through (Rulebook PG 39: A.7)	All Divisions
	12 noon	4-H Cafeteria	Coaches Meeting	All Divisions
	1:00 p.m.	Outside	Trail	A, B, C, D
	11am to 12:00	Indoor	Open jump schooling	Division A Regional A,B,C
	12:00 to 12:45	Indoor	Open jump schooling	Division A Regional D, E
	12:45 to 1:30p.m.	Indoor	Open jump schooling	Division B
	1:30 to 2:00p.m.	Indoor	Open jump schooling	Division C & D
	2:00 p.m.	Indoor	Arena Dragged	
	3:00 p.m.	Indoor	Equitation Over Fences	D, C, A, B
	6:00 p.m.	Indoor	Flag Race	D, C, A, B
8:00 p.m.	Indoor	Opening Ceremonies	All participants	
Friday 10/16/09	7:00 a.m.	4-H Cafeteria	Coaches Meeting	All Division
	8:00 a.m.	Indoor	West. Fit. & Show.	A, D on North B, C on South
	9:30 a.m.	Indoor	Hunt Fit & Show	A, D on North B, C on South
	11:00 a.m.	Indoor	Saddle Seat Fit & Show	A, D on North B, C on South
	12:00 p.m.	Outside	Saddleseat Equation Saddleseat Bareback	B, C B, C
	12:30 p.m.	Indoor	Saddleseat Equation Saddleseat Bareback	A, D A, D
	3:00 p.m.	Outside	Western Riding	A, B, C, D
	4:00 p.m.	Indoor	Speed & Action	A, B, C, D
Saturday 10/17/09	7:00 a.m.	4-H Cafeteria	Coaches Meeting	All Division
	8:00 a.m.	Indoor	Western Equitation Western Bareback	B, C B, C
	8:00 a.m.	Outside	Western Equitation Western Bareback	A, D A, D
	11:00 a.m.	Indoor	Huntseat Equitation	A, B, C, D
	12:00 a.m.	Outside	Huntseat Bareback	A, B, C, D
	4:00 p.m.	Outside	Saddleseat Pattern	A, C only
	4:00 p.m.	Indoor	Cloverleaf	B, D, A, C
	30 minutes after last class of the day	Swine	Pizza Party	All Divisions
Sunday 10/18/09	7:00 a.m.	4-H Cafeteria	Coaches Meeting	All Divisions
	8:00 a.m.	Outside	Saddle Seat Pattern	B, D only
	8:30 a.m.	Indoor	2-Man Relay	A, C, B, D
	30 after last run	Indoor	Closing Ceremonies	All Divisions

ALL Arena / Barn lights out at 11:00pm each night
Lunging in Indoor and Outside 5:00am – 6:30am ONLY
Riding in Covered Arena 5:00 – 6:30am ONLY
Riding in ALL Arena's 6:30 am – 7:30 each morning

Indoor & Outside Arena closed at 7:30 for arena prep, drag & set-up
Indoor & Outside Arena open after all classes are complete for riding

Warm up of Jumpers in the Covered Arena before Open Jump Practice in the INDOOR Arena Please.
Covered Arena open after all classes are complete for the day for touch football / games.



History of the MIHA

Since you are at the MIHA State Championships, you probably know all about the MIHA as it exist today. But we thought you might like to read about how the MIHA got started. The early days of the MIHA are blurry because no official records exist. However, here is what the historian committee was able to uncover.

In 1968, a group of parents were involved in an equine census around the same time. After realizing that there were over 10,000 horses in Oakland County, Ed Cheyz, Kelly Lawrence, and Carmi Edwards purposed a school sponsored horsemanship program to the Huron Valley School Board. The School Board recommended holding a horse show to determine to extent of interest in a horsemanship program.

In 1972, a horsemanship committee was formed and the first ever "Father's Day Show" was held. A portable arena and P.A. system were used to hold the show in front of the Milford High School. The show was so successful that it brought in 1200 spectators, 600 entries, and a profit of \$1,700. This success justified establishing an educational horsemanship program. Ed Cheyz, Kelly Lawrence, and Gerald Fuller presented a proposal to the Board of Education. At the same time, the Director of Community Schools, Carmi Edwards, and the horsemanship committee requested that the Board of Education designate 20 acres of land adjoining Milford High School to be used for the horsemanship program, the annual horse show, and the interscholastic equestrian team program. The horsemanship program passed.

The first equestrian team competition was held in the fall of 1973 at the Bogie Lake Country Club indoor facility between 5 schools, Hartland, Howell, Holly, Fenton, and Milford, with 30 to 40 riders competing. No one remembers the outcome. They only remember that it was so much fun, they just had to do it again. Meets were held again in the spring of 1974, fall of 1974, spring of 1975, and the fall of 1975.

In 1976 due to the expansion of the program statewide, the Huron Valley Interscholastic Horsemanship Association became the Michigan Interscholastic Horsemanship Association. On May 16, 1976 the first MIHA State Championship at Oak Ridge Stables in White Lake Township, with nearly 600 spectators. Winning the State Championship in 1976 was Romeo.

Also instrumental in those early days were Chuck Schroder and Gerald Fuller, the Milford and Hartland coaches. . In 1975, Brighton, coached by Wanda Keech, and Pinckney, coached by Virginia Bennett joined the competition. Also joining in 1975 were teams from New Haven, Romeo, Almont, Oxford, Fowlerville, South Lyon, Novi, Northville, and Lakeland. Most of these schools are still competing today.

Wanda Keech, served as State Chairman, and Virginia Bennett served as Vice-Chairman, during the MIHA's fledgling years. Other past State Chairmen are Bob Kibbie, Phil Tietsort, and Larry Flanary.

By 1978, the MIHA had grown so much it was necessary to divide the schools into "A" division teams (with ten or more riders), or "B" divisions teams (with less than ten riders). At the MIHA State Championship was held in 1978 at Mason, South Lyon won the "A" division and Port Huron won the "B" division that year.

In 1983, Jean Husted became the State Secretary and served until 2004. Other long serving executive board members include Annette Thelen (Treasurer, Vice-Chair, and Jr. Steering Committee) and Bill Tingley (Vice President). By 1984, the MIHA had grown to six districts with 678 riders competing statewide. By 1987 the MIHA had 11 districts with 935 riders competing on 120 teams. In 1992, a "C" division was added for teams with four or less riders. In 1994 the MIHA had 14 districts with 173 teams and 1,118 riders.

In 2004, the MIHA started a pilot program for a Junior division for riders in sixth through eight grades. The Junior division became a formal part of the MIHA in 2006. What a great way to prepare our future high school riders.

By 2005, the MIHA had 2,146 riders on 327 teams in 19 districts. The MIHA State Championships had out grown all available facilities, so it became necessary to add a Regional competition to decrease the size of the State show. The first Regional competitions were held in 2005. In 2006, a "D" Division was added for teams with 2 or less riders. The MIHA had 2,090 riders on 332 team in 19 districts in 2006.

Registration for the 2009 season included 177 Middle School Teams in 18 Districts with 907 riders, and 342 High School Teams in 20 Districts with 1,934 riders.



Spectator & Rider Code of Conduct

Parents, spectators, and coaches are not allowed in the ring at any time.

Parents, spectators, riders, and coaches shall not approach or communicate with the Judges at any time. Only the show staff shall be permitted to communicate with the Judges.

ONLY A COACH, etc. (with proper ID) CAN DROP OR ADD CLASSES.

Only a coach can make a protest. Protest must be made in writing and turned into the show office. Show Staff will communicate with the Judge(s) regarding the protest.

Parents, spectators, riders, and coaches shall not communicate with the announcers while a class is running. You may think it is perfectly innocent to ask the announcer a question while a class is running. Unfortunately, it is very difficult for an announcer to focus on the class while people are asking questions. This is especially true during the "Timed Events" classes, when the announcer is responsible for tracking the times. Please do not interrupt the announcers with questions!

No coaching from the sidelines by parents or spectators.

No alcohol or tobacco is allowed at youth or school activities.

Negative or profane language is strictly prohibited. Article VIII, G,1

Please be respectful of the show grounds. Please adhere to the Midland County Fairground rules found in this booklet. Please help keep the grounds clean.

Be positive! Be respectful! Be patient and understanding!

Be helpful! We always need more volunteers! Remember, if you aren't part of the solution, then you are part of the problem.

Good sports are always winners!!!

*Be gracious when you win,
and graceful when you lose!*



Midland County Fairgrounds Rules

These are Fairground rules and they will be enforced:

NO DOGS ALLOWED!! NO EXCEPTIONS!! No dogs in campers, in cars, or anywhere on the grounds. Anyone caught with a dog on the grounds will be expelled from the show ground.

THE ONLY THING TO BE LEFT IN THE HORSE STALLS ARE SHAVINGS AND MANURE! No straw, Styrofoam, wood pellets, artificial bedding, or trash are to be left in the stalls. Violators will be fined \$75.00.

NO STAPLES OR NAILS ON STALLS OR IN BARNES! Feel free to decorate you stalls, but do not use staples or nails in the barns or anywhere on the grounds.

NO HORSES ON THE GRASS!! No riding, lunging or even walking your horse on any grass area. The only exception to this rule is where the trail class is set up. If you are caught with your horse on a grassy area, you will be expelled from the show ground. Please clean up after your horse.

CAMPING IN CAMPSITES ONLY! Do not plug into barns or other buildings when camping. Please do not park empty trailer or vehicles in campsites. Park in designated areas only.

CLEAN UP AFTER YOURSELVES! Please clean up after yourselves and your horses. All decorations must be completely removed.

MIHA thanks the
Midland County Fairgrounds
for hosting the 35th annual
2009 MIHA State Championship!

2010 MIDLAND COUNTY FAIR

August 15 – 21, 2010

Office & Grounds • 6905 Eastman Avenue • Midland, MI 48642
Phone (989) 835-7901 • Fax (989) 835-2336





MIHA State Championship – THANK YOU!

The MIHA is run by volunteers. The service the volunteers provide is “priceless” because the MIHA would not run without our volunteers. If the MIHA had to pay all of the volunteers what their service is worth, it would not be able to afford the costs. We wish to thank each and every coach, gate keeper, announcer, ring master, set crew, and office worker who helped with our shows this year including District Meets, Regional and the State Championship.

The MIHA would like to thank all of those who took on the difficult task of running our association on a daily basis. Those who volunteer and listen patiently to the parents, students and other volunteers with their many helpful suggestions and concerns, please accept our heart felt – **Thank You!**

Regional Chairpeople

- Region A – Adela Leark (Districts 3, 15, 16, 19)
- Region B – Todd Visga (Districts 1, 2, 7, 12)
- Region C – Hidi Morford (Districts 6, 13, 14, 17)
- Region D – Doyle Fenner (Districts 8, 9, 18, 20)
- Region E – Dennis Stanton (Districts 4, 10, 11, 15)

District Chairpeople

- | | |
|------------------------------------|-----------------------------------|
| District One – Cindy Tesolin | District Eleven – Amy Husted |
| District Two – Fred Stockley | District Twelve – Todd Visga |
| District Three – Judy Stilwell | District Thirteen – Angie Tippin |
| District Four – Terry Scurlock | District Fourteen – Marie Curell |
| District Five – Joel Nyenhuis | District Fifteen – Dennis Stanton |
| District Six – Arlene Koenig | District Sixteen – Steve Luyk |
| District Seven – Myra Zolynsky | District Seventeen – Hidi Morford |
| District Eight – Tiffany Spedowski | District Eighteen – Kris Deisler |
| District Nine – Doyle Fenner | District Nineteen – Adela Leark |
| District Ten – Bill Miller | District Twenty – Beth Harwood |



Midland County Fairgrounds map for

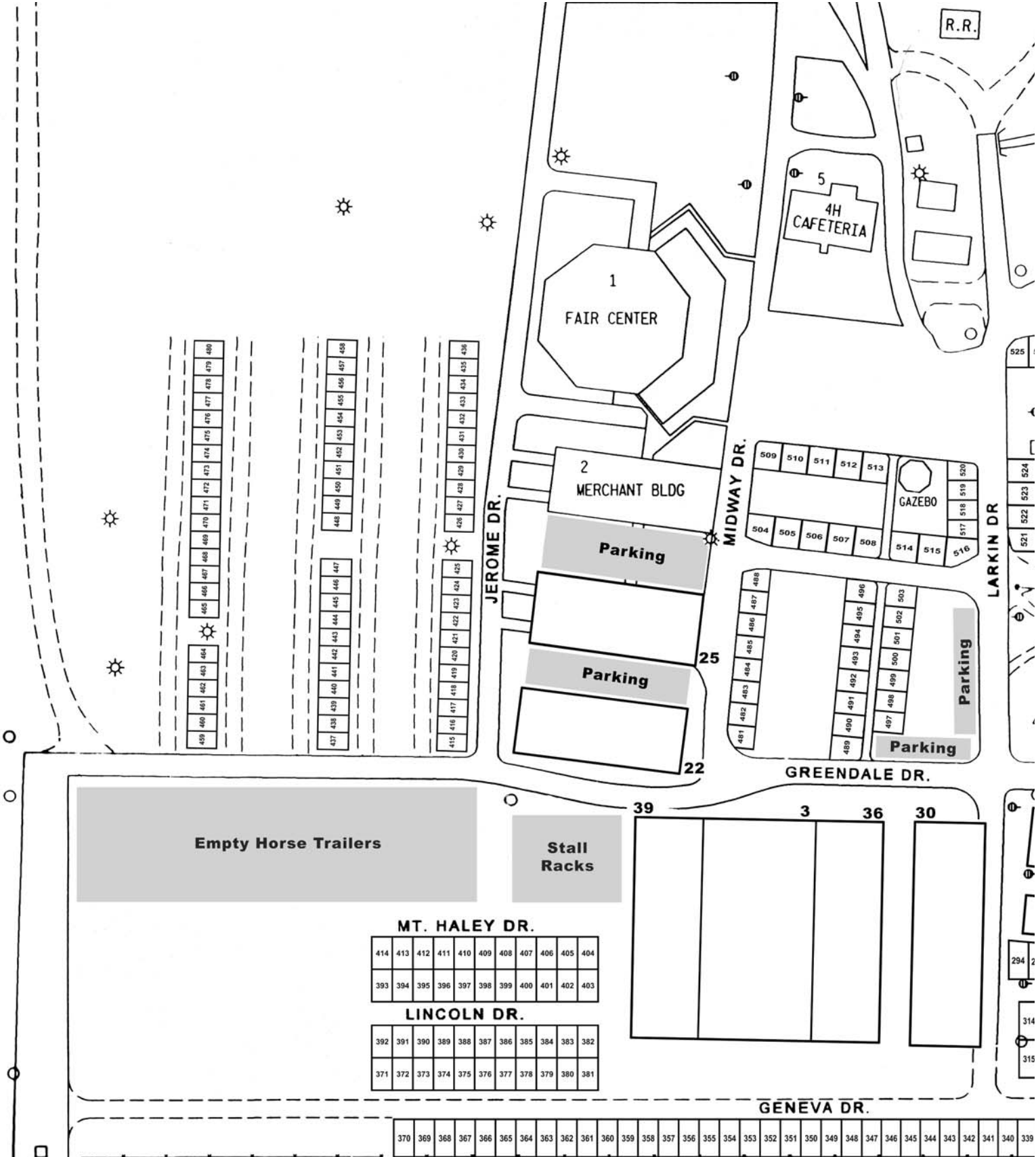

the 2009 MIHA State Championship

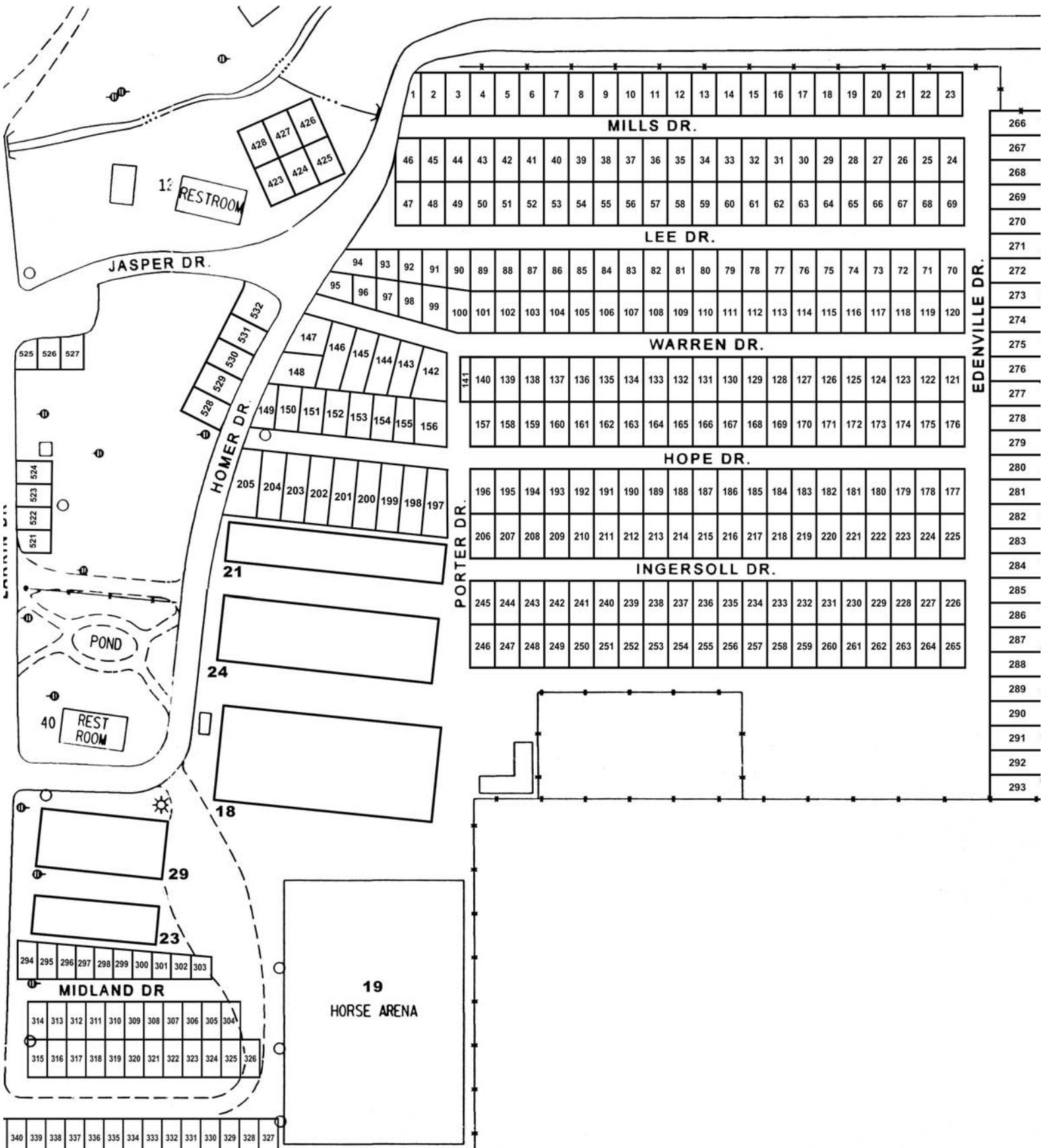

Thank You to



for your accommodations for
MIHA's State Championships!

2100 W. Wackerly St., Midland, MI, US, 48640

Tel: (989) 837-1010 Fax: (989) 837-2470



Thank you
**Michigan
Farm Bureau**
for your support of the
MIHA Regional Meets!

Best wishes to ALL at the State Championship!

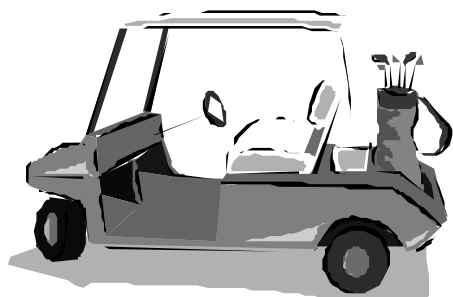

MIHA thanks

Titan Golf Car

203 N Huron Rd
Linwood, MI 48634
(989) 697-3080

for being a sponsor of the
**2009 MIHA State
Championship!**

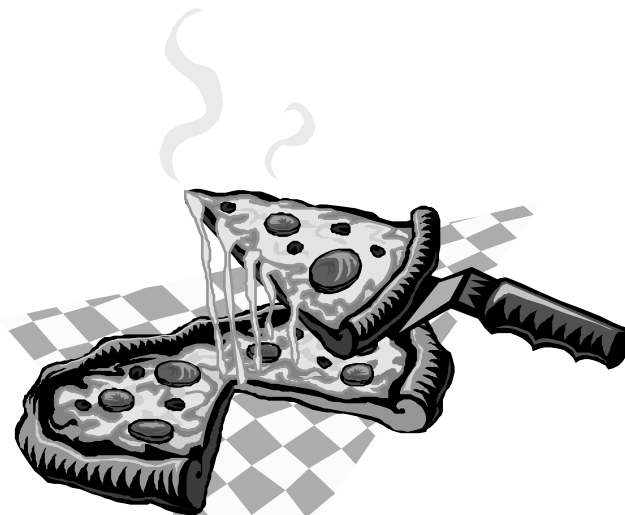

Rider Pizza Party

Saturday, October 17th

*In the SWINE BARN
after the last class of the day –
approximately 6:00 p.m.*



2009 MIHA State Championship Logo Contest

Congratulations to this year's winner...

Sarah Streeter



State Championship Logo Contest Rules

Who can enter? Any MIHA registered rider.

What is the deadline? All entries must be submitted to State Show Chairperson by August 1st, 2010.

What is the prize? Logo will be represented on the 2010 State Championship apparel. Winner's name and school will be listed on the MIHA website. Photo opportunity at the State Championship.

How are the entries submitted? All logos should be submitted via email to: LogoContest@miha.org
Make sure that "MIHA State Championship Logo Contest" is typed into the subject line.

Logo Design Specifications

Theme: All entries must pertain to the subject of horsemanship.

File Format: All entries that are emailed must be in .JPG or .GIF format.

Colors: For cost effectiveness limit of 2 colors per design.

Resolution: Submit all email entries in both (1) low resolution no larger than 150 x 150 pixels and (2) Hi-resolution no larger than 300 x 300 pixels.

Identification Information: All entries must be accompanied with the following: name, address, school, grade and age.

Limit of Entries: There is no limit of the amount of entries you send in.

Usage: Winning logo will be used on the MIHA website as well as various printed items.

Content: The logo must contain the verbiage "MIHA State Championship" and the current year in the design.

Questions or more information: State Show Chairperson or Rules Chairperson



Division "A" Teams

Region A Champions • District 19 • Caledonia

Coaches – Kim Merwin

Assistant Coaches – Sher Ablett, Ford Ablett, Kim Frederick, Kelly Merwin, Meagan O'Brien

125	Mallory DeVoll	231	Taylor Wilcox	328	Jamie Koning
166	Megan Munger	237	Presley Mokma	460	Dakota VandenToorn
202	Hannah Cronin	290	Shelby Upton	469	Kailey Bast
214	Hannah Moody	312	Jen Steffes	494	Kellie Cronin

Region A Reserve Champions • District 5 • Lowell

Coaches – Deb Biggs

Assistant Coaches – Linda Foote, Kelly Foote, Beth VanEns, Michelle Wolf

140	Corryn Bieri	322	Karlie Paulin	391	Kari Bergy
242	Cassie Balfour	331	Zac Graves	413	Leigha Frisbie
245	Mackenzie Roerig	335	Kendall Hewitt	496	Kendra Black
263	Gina Giuliano	359	Emma Roderick		

Region B Champions • District 2 • Oxford

Coaches – Dee Sheppard

Assistant Coaches –

141	Maria Vitucci	260	Jenny Fifield	414	Mandy Moore
142	Amanda Roth	299	Alexandra Logan	436	Colin McGeen
184	Natalie Muskgrove	336	Bekah Bertapelle	452	Mary Cowles
219	Devon Bismack	347	Kayla Kiracoff	454	Logan Standifer
257	Matt Champagne	361	Angie Pollack	482	Meghan Seely

Region B Reserve Champions • District 1 • Milford

Coaches –

Assistant Coaches –

119	Samantha Simmons	258	Morgan Field	363	Lindsey Memering
130	Olivia Pasciolla	271	Megan Alberts	408	Kim Churchwell
149	Shannon Judd	307	Cari Althouse	447	Jocelyn Abbott
196	Morgan Watkins	343	Katherine Slaughter	487	Ally Cunninham
253	Alicia D'Aloisio	356	Ali Dreim		

Region C Champions • District 6 • Bullock Creek

Coaches – Jane Avery

Assistant Coaches – Debbie Arney

101	Julia Tisdale	226	Madison Mulder	321	Becca Gray
127	Kacelyn Pangborn	229	Samantha Marsh	364	Leslie Kissinger
162	Ashley Bartosek	234	Kendra Shankel	406	Kim Squanda
175	Madeline Hays	246	Jeffery Gray	425	Emily Plante
210	Jordan Townsend	251	Susan Avery		
220	Cody Arney	284	Michael Humphery		



Division "A" Teams (continued...)

Region C Reserve Champions • District 17 • Shepherd

Coaches – Linda Vogel

Assistant Coaches – Jim Bradley, Jessica Kutschman, Judy Welsh

204	Taylor Meyers	375	Kaley Lilly	453	Shannon Bradley
267	Carrie Culberson	388	Frankie Baker	459	Devin Brown
302	Anna Travis	421	Whitley Vogel	483	Cassie Conroy
306	Danielle Powell	443	Kolby Brown		
318	Stephanie Jackson	448	Jordan Zimmer		

Region D Champions • District 9 • Ludington

Coaches – Doyle Fenner, Tanya Walter

Assistant Coaches – Lynne Bennett

132	Megan Mast	249	Taylor Avedisian	327	Shawna Hillman
171	Emily Haight	276	Logan Ray	349	Mara Jones
177	Sarah Grubb	285	Maddie Kokx	410	Lexie Preston
188	Jessa Armstrong	294	Alyssa Walter	472	Taylor Kroeze
190	Kelly Leikert	300	Hanna Hawley	477	MacKenzie Brown

Region D Reserve Champions • District 20 • Petoskey

Coaches – Beth Harwood

Assistant Coaches –

111	Heather Nelson	161	Hannah Smith	370	Emily Nowland
116	Jasmine Russell	223	Linsey Stauffer	389	Amanda Brown
128	Emily Love	277	Megham Mitchum	457	Alicia Howard
143	Heather Waldron	278	Nicole Bieganowski	498	Michelle Nellis
153	Kaity Gillis	316	Christina Maskaluk		

Region E Champions • District 11 • Hartland

Coaches – Jennifer Groehn

Assistant Coaches –

109	Taylor Sturtevant	266	Marisa Moskaitis	438	Shelby Stubbs
121	Kendra Hull	374	Chelsea Wojociechowski	463	Nikki Burgess
146	Skylar Welti	419	Tessa Brown	492	Katie Zadorozny
147	Jake Meyers	427	Caci Pippin		
186	Tom Tyson	433	Abbey French		

Region E Reserve Champions • District 4 • Williamston

Coaches – Marcy Best

Assistant Coaches –

136	Kathryn Kendall	319	Rebecca Fettes	415	Rochelle Massa
173	Kiersten McFadden	392	Mattie Nelson	428	Ryan Sturgis
198	Ashten Fettes	396	Nate Massa	471	Brianne Belanger
259	Brooke Janetzke	402	Claire Cooper		



Division "B" Teams

Region A Champions • District 5 • Rockford B

Coaches –

Assistant Coaches –

118	Lindsay Witt	217	Lindsay Davidson	423	Jacquelyn Thome
122	Alexis Thome	264	Catherine Roelse	431	Caitlin Edwards
194	Aubrey Videtich	283	Stephanie Huber		

Region A Reserve Champions • District 3 • Bridgman

Coaches – Cathy Reifschneider

Assistant Coaches – Ali Reifschneider, Sheila Ulrath

160	Emily Ulrath	238	Ashley Kunde	416	Rachel Swords
179	Anna Schmaltz	378	Winter Scheer	450	Kirstin Kuball
212	Elle Barschdorf	379	Ashley Schmaltz	466	Sara Schmaltz

Region B Champions • District 2 • Clarkston

Coaches – Tom Hawkins

Assistant Coaches –

106	Erica Bono	275	Taylor Mceville	479	Emily Hawkins
134	Melissa Bemis	279	Kasey Mckay	485	Darci Molina
155	Amber Olsen	377	Denielle Bouchard		
244	Erin VanBushkirk	464	Alex Wright		

Region B Reserve Champions • District 12 • Eisenhower

Coaches – Sue Kutchev

Assistant Coaches –

112	Elizabeth Kutchev	187	Kelsey Pylar	393	Amy Willaert
174	Taylor Mcfarland	262	Courtney Schoenjahn	395	Natalie Kennedy
181	Lia Biondo	273	Macrina Cipa	434	Lauren Theissen

Region C Champions • District 17 • Mt. Pleasant

Coaches – Aftin Ruhle

Assistant Coaches –

103	Haiely Reihl	458	Allissa Recker	476	Alyson Hill
382	Haley Sommerville	473	Alicia Boulter		

Region C Reserve Champions • District 6 • St. Charles

Coaches – Keith Carey

Assistant Coaches –

100	Montana Kruske	213	Shannon Royal	386	Tess McCallum
102	Nicole Fuller	235	Morgan Carey	439	Justine Burgess
158	Alexis Carey	385	Marissa Lacker		

Region D Champions • District 9 • Grand Haven

Coaches – Jo Ann Kosanic

Assistant Coaches – Chris Frantz, Tom Kosanic

108	Jordyn Vanderlee	240	Carrie Boeve	348	Stephanie Szymas
137	Kaitlin Brace	274	Claire Tillman	490	Elizabeth Brace
225	Samantha Baker	293	Geena Kosanic		



Division "B" Teams (continued...)

Region D Reserve Champions • District 8 • Reed City

Coaches – Amy Wirth-Decker

Assistant Coaches – Mrs. Maciejewski, Sara Morlock

150	Kayci Holmquist	411	Katie Harrington	465	Kelsey Koopman
222	Ciarra Engstrom	420	Kristen Forman	489	Kayla Micek
409	Ginney Miller	432	Cindy Boodt	497	Leah Dawson

Region E Champions • District 4 • Chelsea

Coaches – Lucy Heimerdinger

Assistant Coaches –

165	Tonya Heimerdinger	208	Micayla Zynda	480	Megan Hardcastle
205	Tori Bancroft	426	Rachel Aughton		

Region E Reserve Champions • District 10 • Clinton

Coaches – Laurie Fromhart

Assistant Coaches –

250	Alaina Fromhart	305	Quincy Kittle	412	Lilly Pearce
281	Jessie Graves	320	Samantha Kittle	429	Brooke Stockdale

Division "C" Teams

Region A Champions • District 19 • Northpointe Christian

Coaches – Stacie Bode

Assistant Coaches –

170	Corazon Curtis	372	Cassidy Curtis	405	Emma Geers
254	Kristie Sikma				

Region A Reserve Champions • District 5 • Grant

Coaches – Andrea Crandall

Assistant Coaches – Brittllynn Hoofman

107	Rebecca Roeters	203	Spencer Tellkamp	357	Chandler Hoekstra
185	Nicole Brock	339	Amy Bouwkamp		

Region B ***Co-Champions*** • District 1 • Howell

Coaches –

Assistant Coaches –

164	Jenny Fuson	216	Dani Pranke	333	Angie Johnson
189	Ashlee Conway	301	Brianne Rajala		

Region B ***Co-Champions*** • District 2 • Lapeer East

Coaches – Carma Capizzo

Assistant Coaches –

131	Morgan Warda	337	Cara Capizzo	383	Brianna Reis
311	Kayla Dewitt				



Division "C" Teams (continued...)

Region C Champions • District 14 • Sandusky

Coaches – Diane Stone

Assistant Coaches – Kim Alexander, Jill Kursomsky

197	Emily Stone	211	Stephanie Smith	241	Nicholas Stone
206	Katie Krueger				

Region C Reserve Champions • District 6 • Heritage

Coaches – Maureen Case

Assistant Coaches –

113	Karly Boettcher	430	Abby Cline	486	Hillary Case
-----	-----------------	-----	------------	-----	--------------

Region D Champions • District 9 • Providence Christian

Coaches – Heidi Oosting

Assistant Coaches –

243	Ashley Schaner	381	Sheyenne Nelson	470	Christine Michael
-----	----------------	-----	-----------------	-----	-------------------

Region D Reserve Champions • District 8 • Ewart

Coaches – Stacie Dennis

Assistant Coaches –

193	Saige Nabonzy	288	Kelsey Dennis	362	Kortney Dennis
-----	---------------	-----	---------------	-----	----------------

Region E Champions • District 10 • Onsted

Coaches – Alisha Morton

Assistant Coaches –

227	Kayla Brighton	358	Monica Boyce	403	Rachel Shadbolt
280	Shannon Brown				

Region E Reserve Champions • District 15 • Mendon

Coaches – Diane Zinsmaster

Assistant Coaches –

139	Cassie Lewis	308	Tiffani Spealman	317	Ashley Zinsmaster
-----	--------------	-----	------------------	-----	-------------------

Division "D" Teams

Region A Champions • District 3 • Coloma

Coaches – Lori Romeo

Assistant Coaches – Tammara Kettlehut

120	Sarah Kettlehut	456	Mikayla Romeo
-----	-----------------	-----	---------------

Region A Reserve Champions • District 19 • Saranac

Coaches – Tracy Bussa

Assistant Coaches – Robert Bussa, Anetra Whalon

157	Taylor Whalon	233	Tiffany Ferris
-----	---------------	-----	----------------



Division "D" Teams (continued...)

Region B Champions • District 7 • Southgate

Coaches – Kim Clapp

Assistant Coaches –

180 Katelyn Clapp 399 Chelsea Owen

Region B Reserve Champions • District 2 • Shrine

Coaches – Susan Rokosz

Assistant Coaches –

346 Alexksandra Rokosz

Region C Champions • District 13 • Fairview

Coaches – Robbie Handrich

Assistant Coaches – Deanna Hiser

163 Kendra Handrich

Region C Reserve Champions • District 6 • Swan Valley

Coaches – John Strecker

Assistant Coaches – Anne Wade

270 Cassandra Wade 303 Natasha Strecker

Region D Champions • District 11 • Traverse City St. Francis

Coaches – Ginny Deisler

Assistant Coaches –

169 Chelsea Deisler

Region D Reserve Champions • District 8 • Crossroads Charter Academy

Coaches – Darlene Bozek

Assistant Coaches –

123 Amber Bedgood 350 Eliese Bittner

Region E Champions • District 15 • Pennfield

Coaches – Tamera Entsminger

Assistant Coaches –

209 Cheyann Entsminger

Region E Reserve Champions • District 10 • Lenawee Christian

Coaches – Teresa Squires

Assistant Coaches –

176 Charlotte Squires 441 Paige Neblo



CONGRATULATIONS BULLOCK CREEK Region C Champions!

COACH:
JANE
AVERY

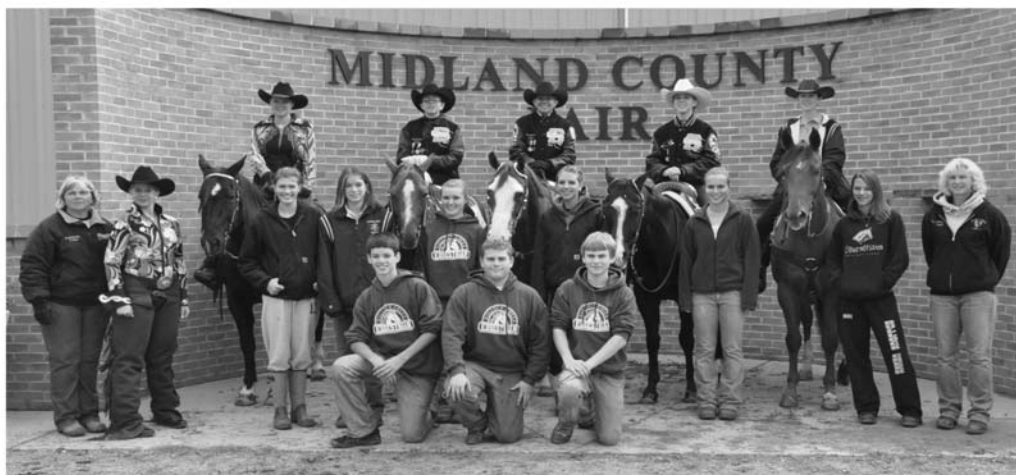

ASSISTANT
COACH:
DEB ARNEY

Kimberlee Squanda
Maddie Hayes
Micheal Humphrey
Kendra Shankel

Becca Gray
Cody Arney
Emily Plante
Julia Tisdale

Susan Avery
Ashley Bartosek
Jeff Gray
Leslie Kissinger

Samantha Marsh
Jordan Townsend
Maddie Mulder

GOOD LUCK AT STATES!

GO CREEK!!!

Good Luck Kendra

Go Eagles

LOVE MOM & KREIG



The Detroit Polo Club

Thomas A. Hamway, DDS, MS
Timothy G. Stroster, DDS, MS
Specialists in Orthodontics and Dentofacial Orthopedics



Northern Industrial Construction

Equine Performance Services Dr. Diane Troyer

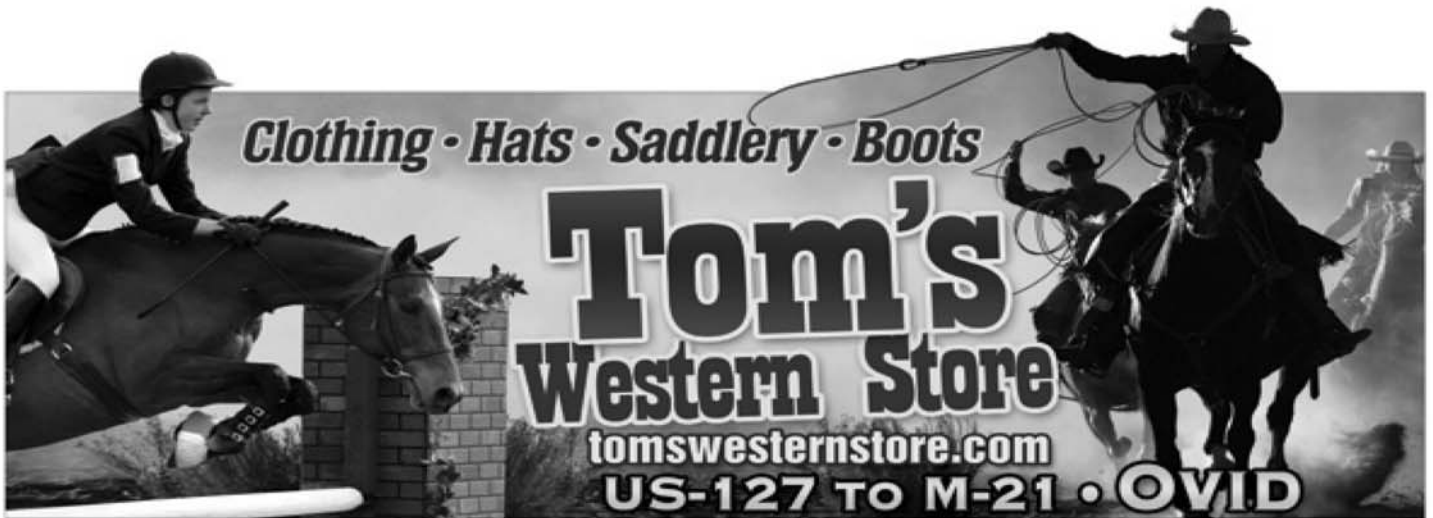

Tom's Would Like to Congratulate All of the MI State High School Equestrian Team Finals Participant's

*Come visit us for the latest in Circle Y • Billy Cook • Fabtron • Stubben •
Ariat • Cinch • Cruel Girl • Wrangler • Bailey • Professional Choice •
Montana Silversmith and many more brands!*

Make This Year A Cowboy Christmas Under Your Tree From Tom's Western Store!

COUPON

Take **25% OFF** any Single Regular Price Item.

This Coupon Excludes Used, Consignment, Regular Priced Western & English Saddles, Special Tagged,
Sale Items and Wormers. Coupon Can be Used Instore & Online!
One Coupon per household.

Hurry...Offer Expires November 30, 2009.

Coupon Code: TWSMIHASTATESHOW

Coupon Code: TWSMIHASTATESHOW

COUPON

Check Our Website For More Information & Specials!

TOM'S WESTERN STORE

One Mile West of Ovid on M-21 • 8982 East M-21, Ovid, MI 48866

**GIFT
CARDS**

www.tomswesternstore.com
1-800-830-5446 or (989) 834-5446

**SADDLE
FITTINGS**

DISTRICT VII

**WOULD LIKE TO SEND GOOD LUCK WISHES TO ALL THE TEAMS
PARTICIPATING AT THE 2009 MIHA STATE CHAMPIONSHIPS**

**ALLEN PARK
ANN ARBOR GREENHILLS
ANN ARBOR HURON
ANN ARBOR PIONEER
ANN SKYLINE
BELLEVILLE
AIRPORT (CARLETON)
DEXTER
GROSSE ILE
HURON (NEW BOSTON)
LADYWOOD
LINCOLN (YPSILANTI)
MANCHESTER
MILAN
MONROE
SOUTHGATE
ST. MARY'S CATHOLIC CENTRAL (MONROE)
SUMMIT ACADEMY (NEW BOSTON)
TRENTON
WASHTENAW CHRISTIAN ACADEMY
JOHN GLENN (WESTLAND)
WOODHAVEN**

**CONGRATUALATIONS TO OUR DISTRICT CHAMPIONS
A DIVIONS - MANCHESTER
B DIVISON - ANN ARBOR SKYLINE
C DIVISION - HURON (NEW BOSTON)
D DIVISION – SOUTHGATE
AND TO OUR SPORTSMANSHIP WINNER DEXTER**

**CONGRATULATIONS TO OUR REGION B CHAMPION – D DIVISION
SOUTHGATE ANDERSON
RIDERS: KATELYN CLAPP AND CHELSEA OWENS, COACH: KIM CLAPP**

**GOOD LUCK TO OUR LITTLE BUT MIGHTY
D TEAM AT STATES**

GO SOUTHGATE ANDERSON



WOOD SHAVINGS FOR PAPER

CN Sawdust

616-430-1958

www.cnsawdust.com
joel@cnsawdust.com

Paper shavings are becoming more and more popular. Because they are relatively dust free and are consistent in size, you need less to cover the same area as conventional wood shavings. They are non-toxic, non-allergenic, biodegradable and Made from 100% RECYCLED PAPER

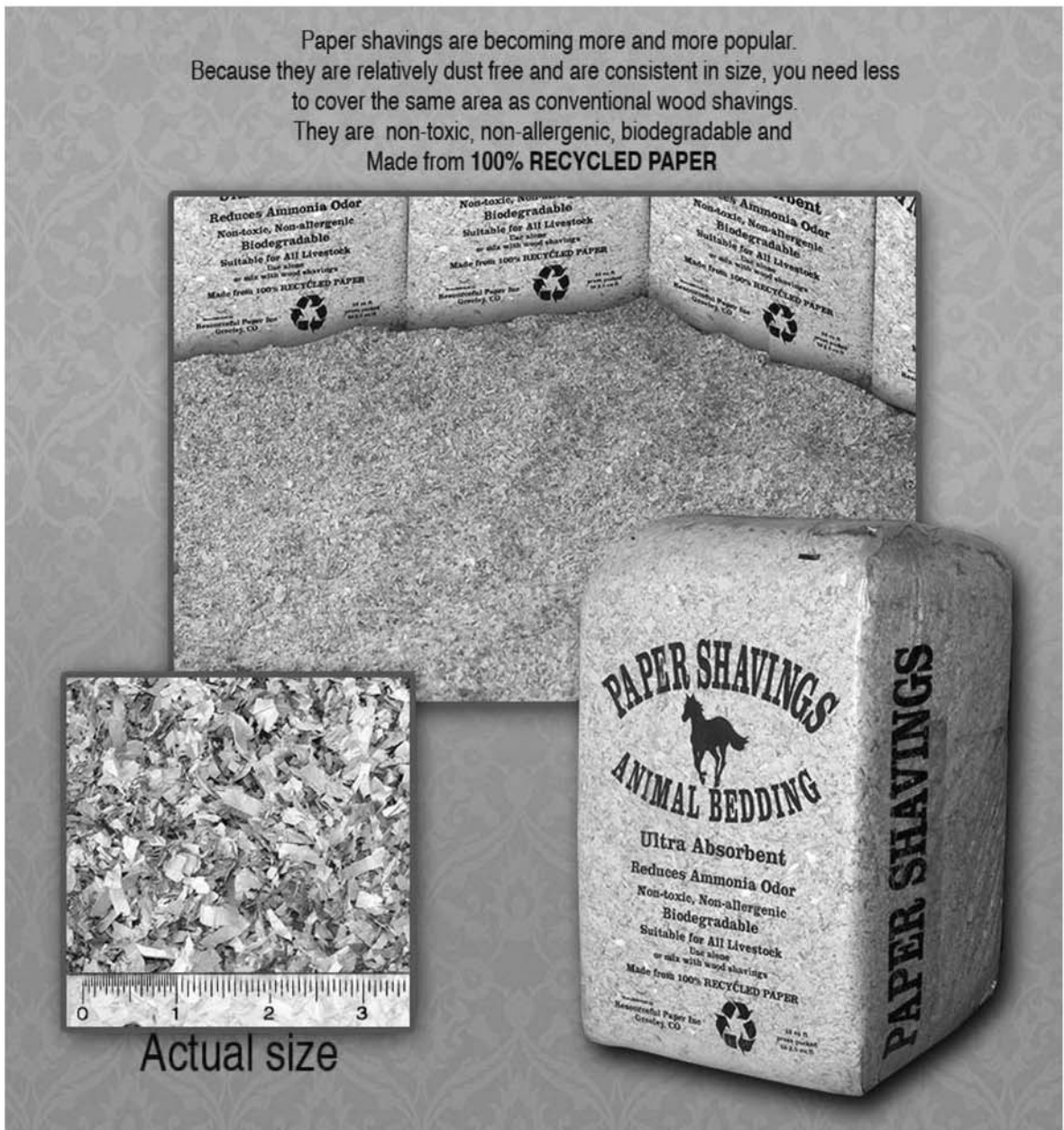

*Heritage Equestrian Team from Saginaw wishes everyone
a safe and successful State Championship Meet!!!*

GO HAWKS!!! YOU ROCK!!!

Riders:

Abby, Hillary and Karly

Coaches:

Maureen and Nicole



2009
Bullock Creek



Equestrian Team



CONGRATULATIONS



DISTRICT 1



SINCE 1973

A Division Teams

Milford South Lyon East Lakeland Howell

B Division Teams

Milford Stevenson Mercy Holly

WALLED LAKE NORTHERN Plymouth Novi Salem

C Division Teams

Howell Whitmore Lake South Lyon Canton

Farmington WALLED LAKE WESTERN & CENTRAL

**THANK YOU
COACHES, PARENTS
&
FAMILY
FOR YOUR LOVE & SUPPORT**



We enjoyed the season, keep it going.

THANK YOU MIHA

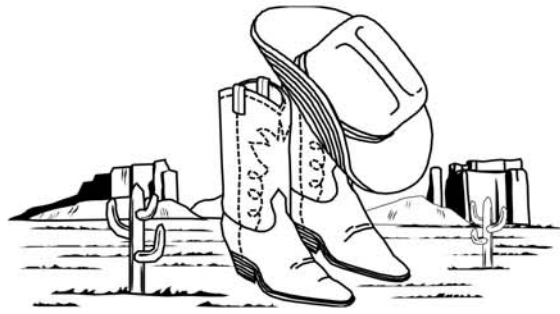

District 19 Champions

Caledonia – Division A – Region A Champions

Hastings – Division B

North Pointe Christian – Division C – Region A Champions

Saranac – Division D – Region A Reserve Champions

CONGRATULATIONS

Caledonia
East Kentwood
Gull Lake
Ionia
Maple Valley
Saranac
Thornapple Kellogg



Delton Kellogg
Grand Rapids Christian
Hastings
Lakewood
North Pointe
South Christian
Wayland

Good Luck at the State Finals
Caledonia, North Pointe & Saranac

The essential joy of being with horses is that it brings us in contact with the rare elements of grace, beauty, spirit, and fire. ~Sharon Ralls Lemon



Congratulations District 14 Champions

Croswell-Lexington

Division A

Lakeville

Division B

Sandusky

Division C

Deckerville

Division D

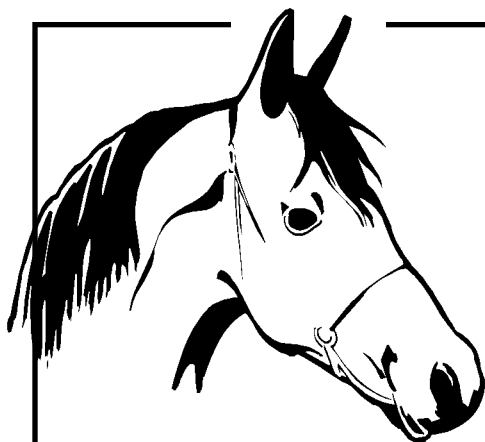

Congratulations

*to the District 6 teams going the
State Championship Meet!*

Bullock Creek

Region C, Division A Champions

Coaches – Jane Avery, Debbie Arney

Julia Tisdale
Kacelyn Pangborn
Ashley Bartosek
Madeline Hays

Jordan Townsend
Cody Arney
Madison Mulder
Samantha Marsh

Kendra Shankel
Jeffery Gray
Susan Avery
Michael Humphery

Becca Gray
Leslie Kissinger
Kim Squanda
Emily Plante

St. Charles

Region C, Division B Reserve Champions

Coach – Keith Carey

Montana Kruske
Nicole Fuller

Alexis Carey
Shannon Royal

Morgan Carey
Marissa Lacker

Tess McCallum
Justine Burgess

Heritage High

Region C, Division C Reserve Champions

Coach – Maureen Case

Karly Boettcher

Abby Cline

Hillary Case

Swan Valley

Region C, Division D Reserve Champions

Coaches – John Strecker, Anne Wade

Cassandra Wade

Natasha Strecker

**Thank you to all of our riders, coaches and parents for
making 2009 a great season in MIHA District 6!!!**

Rick's Tack

& SUPPLY SHOP LLC

100 60th Ave
Hartford, MI 49057
(269) 621-3069

www.rickstackonline.com

STATE SHOW VENDOR!

GOOD LUCK SWAN VALLEY !



**CASSANDRA
& NATASHA**

Congratulations Regional Champions

**Good Luck at the MIHA State
Championship Meet at the
Midland County Fairgrounds**

*From the Coaches, Riders,
Grooms and Parents
at Bay City Western
District VI, Division B*



LOWELL A TEAM Congratulations!

Cassie Balfour
Kari Bergy
Kendra Black
Corryn Bieri
Leigha Frisbie
Gina Giuliano

Zac Graves
Kendall Hewitt
Karlie Paulin
Mackenzie Roerig
Emma Roderick

Ride 'n Slide with RED ARROW PRIDE!!!

Thanks to ALL of the Lowell parents & friends
for your awesome support!!!

**Lowell Coaching Staff:
Deb, Linda, Jess, Travis, Jessi, Kelly**



2009 MIHA State Championship Show Evaluation

Please take a minute to complete and turn in this evaluation form. Please circle your response with 5 being the best and most satisfactory, and 1 being the worst and least satisfactory.

1) How did you like attending the Championship in Midland, Michigan?

5 4 3 2 1

2) Overall quality of the Midland County Fairgrounds?

5 4 3 2 1

3) Overall quality of the camping facilities at the Midland County Fairgrounds?

5 4 3 2 1

4) The efficiency of the Office and Show staff?

5 4 3 2 1 or did not deal with show office/staff

5) How friendly and polite was the Office and Show Staff?

5 4 3 2 1 or did not deal with show office/staff

6) How would you rate the show schedule?

5 4 3 2 1

7) If you or your team filed any formal protest, how well did the show committee handle your protest?

5 4 3 2 1 or did not file any protest

8) How timely was the show run each day?

Thursday	5	4	3	2	1
Friday	5	4	3	2	1
Saturday	5	4	3	2	1
Sunday	5	4	3	2	1

9) How do you rate this year's State Championship overall?

5 4 3 2 1

10) Is there anything you would like to see changed for next years Championships?

ADDITIONAL COMMENTS _____



Congratulations

Shepherd High School

District 17, Region C

Frankie Baker
Shannon Bradley
Devin Brown
Kolby Brown
Cassie Conroy

Carrie Culbertson
Stephanie Jackson
Kaley Lilly
Taylor Myers
Danielle Powell

Anna Travis
Whitley Vogel
Jordon Zimmer

Coach - Linda Vogel

Assistant Coach - Jim Bradley, Speed

Assistant Coach - Jessica Kutschman, Jumping

Assistant Coach - Judy Welsh, Eq., Showmanship, Trail

The family and friends thank all riders for your continued hard work and dedication. Best of luck at State MIHA!

“Go Get ‘em Blue Jays!”



CONGRATULATIONS DISTRICT 9 TEAMS

First at Regional

Division A—Ludington High School

1st row—Shawna Hillman, Sara Grubb, Megan Mast, Emily Haight, Lexie Preston, Mascot “Oli”, coach Doyle Fenner; 2nd row—Jessa Armstrong, Hannah Hawley, McKenzie Brown, Maddi Kokx, Taylor Kroeze; 3rd row—coach Tanya Walter, groom Emilie Walter, Alyssa Walter, Logan Ray, Kelly Leikert, groom Claire Leikert, coach Lynne Bennett, and Taylor Aveisian



Division B—Grand Haven

Coach Jo Ann Kosanic, Samantha Baker, Carrie Boeve, Geena Kosanic, Coach Chris Frantz, Stephanie Szymas, Claire Tillman, Coach Tom Kosanic, missing from photo Elizabeth Brace, Kaitlin Brace and Jordyn VanderLee



Division C—Providence Christian

Sheyenne Nelson, Christine Michael, Ashley Schaner, Coach Heidi Oosting

